

### Contents

- M10, Steel Eyebolt – 3 each
- Conical Spring Washer – 3 each
- User Manual TD-000289-00
- Warranty Statement TD-000453-01.



### IMPORTANT SAFETY INSTRUCTIONS



**NOTE:** The intent of the exclamation point within an equilateral triangle is to alert the user to the presence of important safety, and operating and maintenance instructions in this manual.

Before placing, installing, rigging, or suspending any speaker product, inspect all hardware, suspension, enclosures, transducers, brackets and associated equipment for damage. Any missing, corroded, deformed, or non-load rated component could significantly reduce the strength of the installation or placement. Any such condition severely reduces the safety of the installation and should be immediately corrected. Use only hardware which is rated for the loading conditions of the installation and any possible short-term, unexpected overloading. Never exceed the rating of the hardware or equipment.

Consult a licensed, Professional Engineer regarding physical equipment installation. All local, state and national regulations regarding the safety and operation of equipment are understood and adhered to.

- Use only load rated hardware to attach to the eyebolts when suspending these products.
- Do not suspend these products from any structural element on the enclosure other than the load rated M10 suspension points.
- Install in accordance with instructions by QSC, LLC instructions and under the supervision of a licensed Professional Engineer.

## Vertical Suspension of Composite Loudspeaker Enclosures

### Install Two Surface Eyebolts

Refer to — Figure 1

1. On the enclosure, locate the two adhesive plastic covers, protecting the enclosure's M10 threads, and remove them.
2. Place one conical spring washer onto the threaded portion of an eyebolt and carefully thread the eyebolt assembly into the enclosure's threads. Repeat for the other M10 fitting.
3. Tighten each eyebolt until shoulder is snug against the spring washer and the spring washer is snug against the enclosure. Tighten the eyebolts down and then continue to rotate until they are positioned as desired.

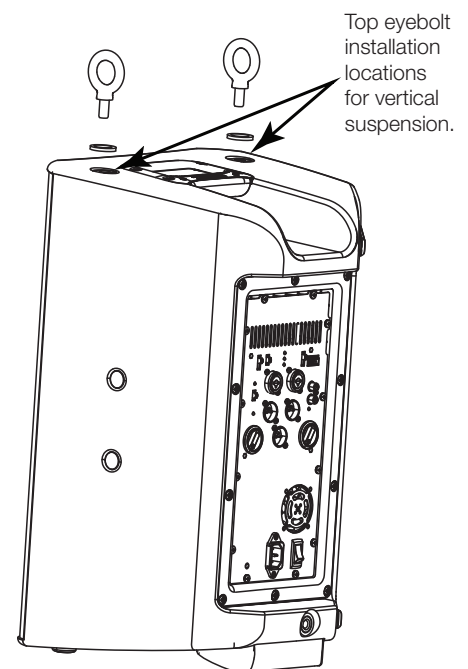

— Figure 1 —



## Install One Pull-back Eyebolt (K Series and KLA12)

Refer to — Figure 2.

1. At the rear of the enclosure, just below the amplifier module, locate the adhesive plastic cover, which protects the enclosure's M10 thread, and remove it.
2. Place one conical spring washer onto the threaded portion of an eyebolt and carefully thread the eyebolt assembly into the enclosure's threads.
3. Tighten each eyebolt until shoulder is snug against the spring washer and the spring washer is snug against the enclosure. Tighten the eyebolts down and then continue to rotate until they are positioned as desired.

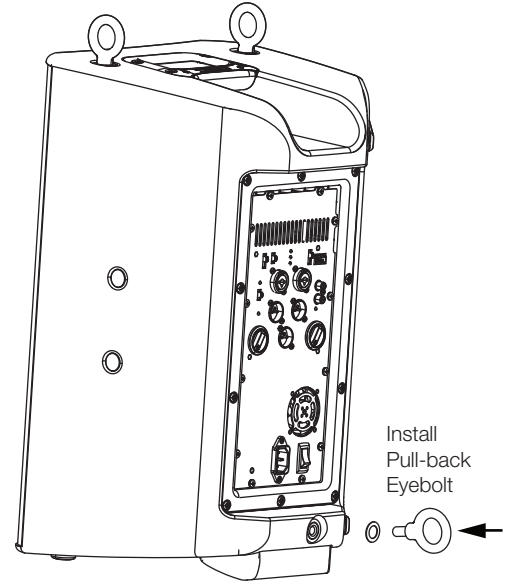

— Figure 2 —

## K.2 Series Suspension

Refer to — Figure 3.

The K.2 Series loudspeakers each have two M10 suspension points, and one pull-back ring.

1. M10 suspension points
  - a. On the enclosure, locate the two adhesive plastic covers (1), protecting the enclosure's M10 threads, and remove them.
  - b. Place one conical spring washer onto the threaded portion of an eyebolt and carefully thread the eyebolt assembly into the enclosure's threads. Repeat for the other M10 fitting.
  - c. Tighten each eyebolt until shoulder is snug against the spring washer and the spring washer is snug against the enclosure. Tighten the eyebolts down and then continue to rotate until they are positioned as desired.
2. Pull-back ring – attach the suspension cabling to the pull-back ring (2).

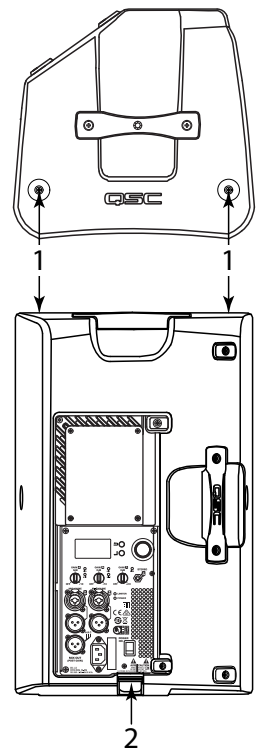

— Figure 3 —